

Technical Report

Geonair

Database Version : 1.05
 Pricing Version : 2015.04.28
 Project Name : 408
 Order Name : 1
 Unit Code : MKZ2127CC

Job Serial No. : MAHU-01
 Quantity : 1
 Location : UAE

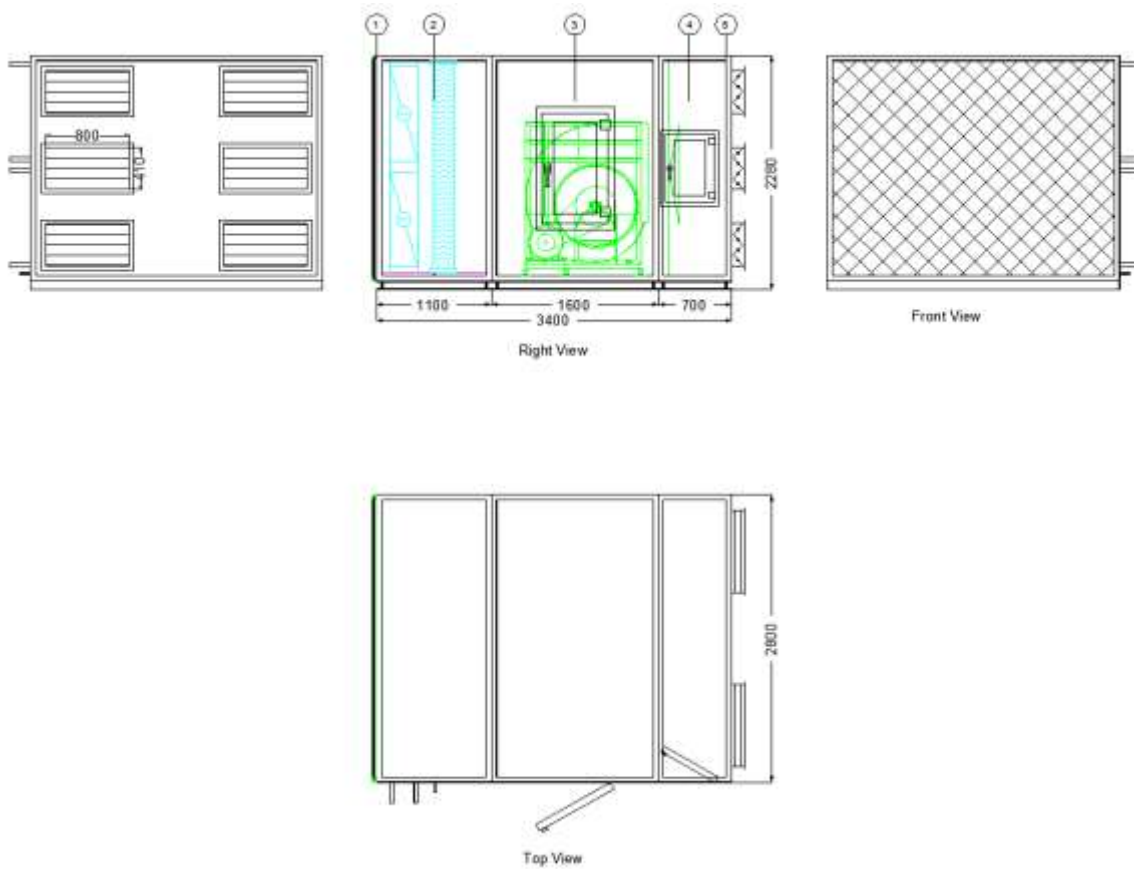

General Specifications

Season :	Summer & Winter	Entering Air Type :	Fresh Air
Unit Orientation :	Horizontal	Unit Height (Top) :	0 mm
Coil Header Loc. :	Right Type	Unit Height (Bottom) :	2200 mm
Canopy :	No	<i>*This dimension not include base height</i>	
Installation :	CPT		

Design Criteria

Supply Blower		Exhaust Blower	
Supply Air Flow :	40703 m ³ /h	Exhaust Air Flow :	0 m ³ /h
Fresh Air Flow :	40703 m ³ /h	EP :	0 Pa
ESP :	1300 Pa		

* ESP = External Static Pressure, TP = Total Pressure, EP = External Pressure, SP = Static Pressure

Temperature Profile

Summer

DB (Fresh Air) :	46.00 °C	DB (Return Air) :	27.00 °C
WB (Fresh Air) :	30.00 °C	WB (Return Air) :	19.50 °C
RH (Fresh Air) :	31.8 %	RH (Return Air) :	49.9 %

Winter

DB (Fresh Air) :	10.00 °C	DB (Return Air) :	15.00 °C
WB (Fresh Air) :	6.00 °C	WB (Return Air) :	12.00 °C
RH (Fresh Air) :	55.0 %	RH (Return Air) :	70.8 %

Unit Specifications

Inner Material :	GI	Outer Material :	Color Steel
Inner Thickness :	0.5 mm	Outer Thickness :	0.5 mm

Pricing Version : 2015.04.28

Project Name : 408

Job Serial No. :

Order Name : 1

Quantity : 1

PU Thickness : 50 mm Base Material : 8#Steel Base
PU Material : Polyurethane-PU Base Height : 80 mm
Unit Dimension : L*W*H 3400*2800*2280 mm Weight : 2136 kg

1 Exterior Filter

Type : Plate Type Grade : G3
Brand : Factory Design Design PD : 80 Pa
Installation : Sliding Spare Filter : 0 Set
Section Depth : 0 mm Pressure Drop : 80 Pa
Weight : 103 kg Self Supplied : No

2 Cooling Coil

Coil Specifications		Air Side		Water Side	
Coil Row	: 10	Entering		Entering Temp.	: 7.00 °C
FPI	: 10	Actual Air Flow	: 40703 m³/h	Leaving Temp.	: 12.00 °C
Tube Height	: Mid-30,Btm-30	DB Temp.	: 46.00 °C	Water Velocity	: 1.79 m/s
Fin Length	: 1170 mm	WB Temp.	: 30.00 °C	Flow Rate	: 42.55 L/s
Fin Height	: 1651 mm	RH	: 31.8 %	Water Pressure	: 45.15 kPa
Circuiting Method	: Q	Leaving			
Tube Diameter	: 1/2"	DB Temp.	: 11.90 °C		
Tube Material	: Copper	WB Temp.	: 11.85 °C		
Fin Material	: Standard AL	RH	: 99.4 %		
Drain Pan	: Yes	Coil Performance			
Drain Pan Mat.	: GI Spray	Coil Face Area	: 2.54 m/s	Pressure Drop	: 306 Pa
ME	: Yes	Cooling Cap.	: 893.28 kW	Section Depth	: 1100 mm
ME Material	: Aluminium	Air Pressure	: 226 Pa	Weight	: 790 kg
Header Size	: DN80				
Qty 1	: 4 unit	Coil Model 1	: HRQBJ.QB5FY10*30*1170		
Qty 2	: 0 unit	Coil Model 2	: HRQBJ.QB5FY10*30*1170		
Qty 3	: 0 unit	Coil Model 3	: -		

3 Supply Fan

Fan		Motor		Others	
Brand	: Yilida	Brand	: Factory Design IP55	Used Air Flow	: 40703 m³/h
Model	: SYQ710-Z	Power	: 30.00 kW	Outlet Type	: No
Absorbed Power	: 27.00 kW	Elec. Supply	: 380 V/3Ph	Actuator	: -
Max Absorb. Power	: 60 kW	Frequency	: 50 Hz	Activator	: No
Speed	: 1560 rpm	Type	: Invertor		
TP	: 1854 Pa	Pole	: 4		
TSP	: 1736 Pa	Quantity	: 1 unit		
Blower Type	: Backward	Location	: Side		
Disch. Velocity	: 14.02 m/s				
Disch. Direction	: Rear Discharge				
Disch. Opening	: 898*898				
Static Efficiency	: 72.7 %				
Total Efficiency	: 77.6 %				
Blower Quantity	: 1 unit				
Door Type	: Door	Door Location	: Right	Marine Lamp	: No
Quantity	: 1				
Section Depth	: 1600 mm	Weight	: 876 kg		

4**Diffuser**

Model : JLB-710
 Door Type : Door Door Location : Right Marine Lamp : No
 Quantity : 1
 Section Depth : 600 mm Pressure Drop : 50 Pa Weight : 176 kg

5**Outlet Section**

Name : Outlet Section

Rear Opening

Dimension (WxH) : 410*800(*6) mm Actuator : SMU24 Opening Type : Aluminium Damper (elec
 Section Depth : 100 mm Pressure Drop : 0 Pa Weight : 139 kg

No.	Item Name	Quantity
-----	-----------	----------

No.	Item Name	Quantity
-----	-----------	----------

No.	Item Name	Quantity
-----	-----------	----------